

Step 1: Locate the vehicle's OBDII port. The port is usually located under the driver's side dashboard. However, the location of the OBDII port varies with each vehicle, as the port may be located under the passenger's side dashboard or in the center console. Free up the vehicle's OBDII port from its existing location.

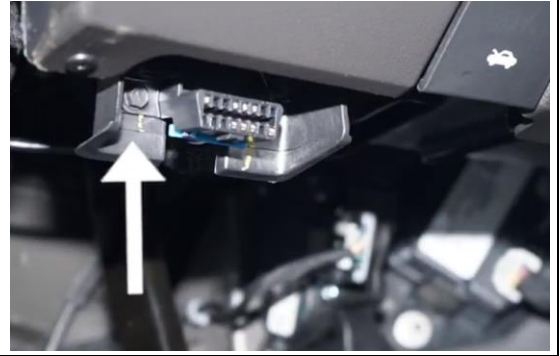

Step 2: Free up the vehicle's existing OBDII port by either removing the two screws or body panel clips holding the port in place.

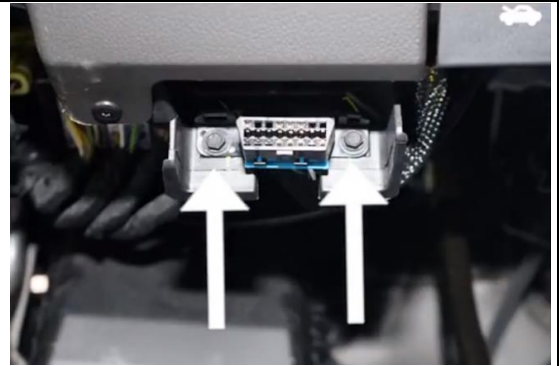

Step 3: Mount the replacement OBDII port on the Y-Cable. Connect the OBDII Y-Connector Cable to the vehicle's OBDII port that you just removed. Then mount the Y-connector cable OBDII port to the old OBDII location.



NOTE: The OBD II Y-Connector Cable helps ensure the OBD II Device is always connected to the vehicle's OBDII PORT. With enough cabling to reposition the GPS tracker, this connector cable helps to ensure that your alerts and reports remain as accurate as possible



Step 4: Connect the OBD II tracking device to the OBDII Y-Connector Cable. Once connected, find a position away from steel plating to store the OBD II device where it can establish a solid connection.

NOTE:

- Once installed, the device may take up to several hours to connect to a cellular network
- Use wire ties to secure the device and cable

